

112 PAX

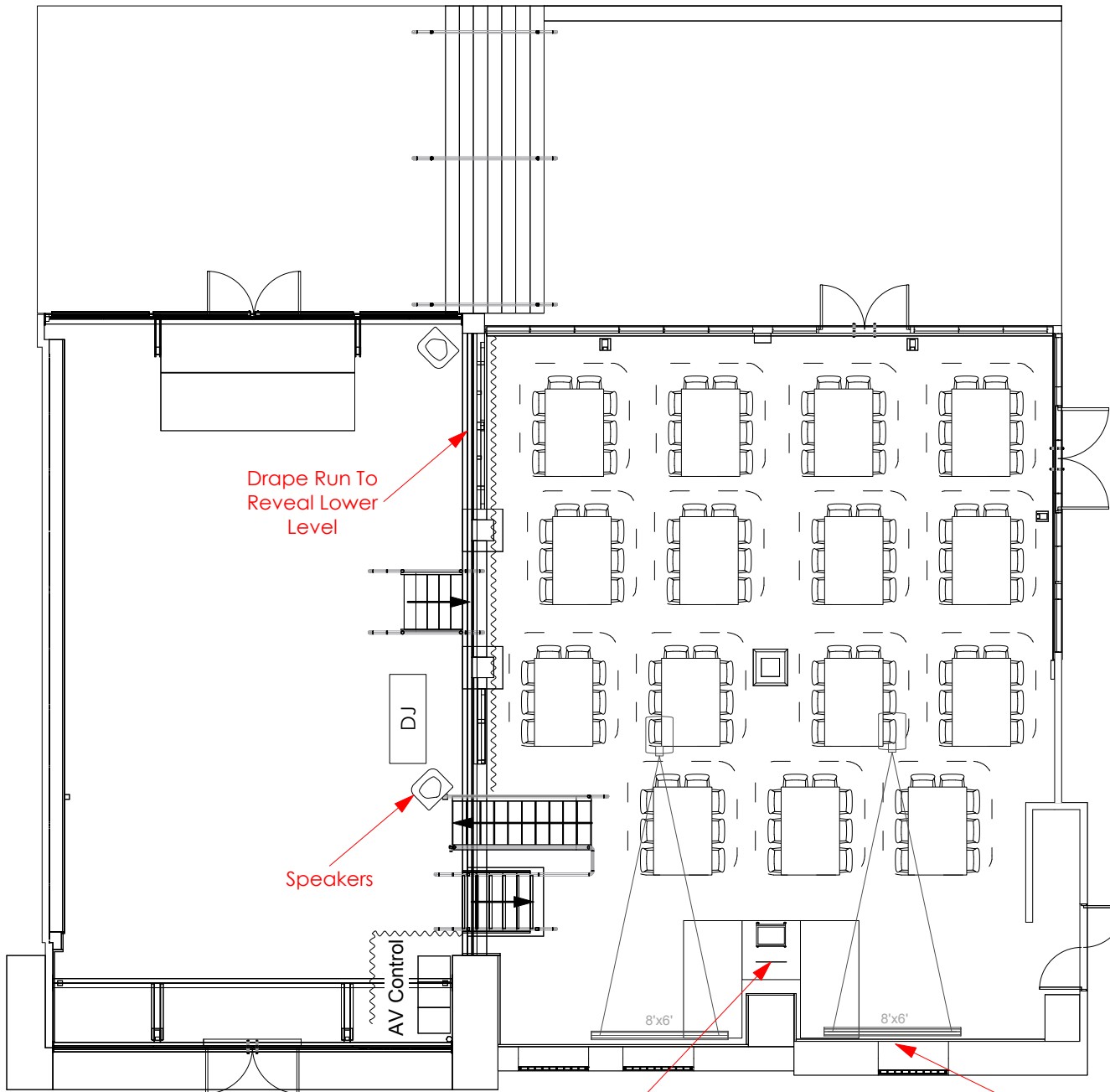

**Simmer On The Bay**  
 13 Hickson Road, Walsh Bay  
 Sydney 2000  
 e [events@simmeronthebay.com.au](mailto:events@simmeronthebay.com.au)  
 w [www.simmeronthebay.com.au](http://www.simmeronthebay.com.au)  
 p 02 9247 2457



Drape Run To Reveal Lower Level

Speakers

AV Control

DJ

Stage And Lectern

2 X Projectors and Screens

**Available Venue Furniture**

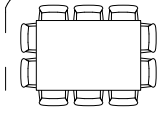

Dining Table 1.8m X 1.2m



145 X White Chairs 0.6m Wide X 0.5m Deep



Plastic Trestle Table 1.82m X 0.75m X 0.75m

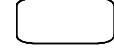

12 X Daybeds 1.68m X 0.78m X 0.43m

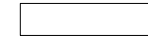

1 X Green Table 2.35m X 0.55m



9 X Adjustable Round Cocktail Tables  
 0.6m Dia X 0.6-0.9m High

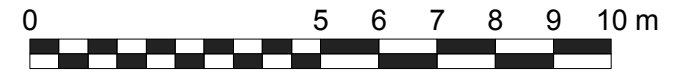

PROJECT	CONFERENCE STYLE 14 TABLES OF 8		
VENUE	SIMMER ON THE BAY		
CLIENT	CLIENT		
DWG	SIMMER ON THE BAY V3	EVENT DATE	00/00/00
		DRAWN BY	HS
		SHEET #	1
		VERSION	1
Innovative Production Services Unit 6 Military Road, Matraville 2036, Sydney NSW p 02 9311 9100 f 02 9311 9199 e <a href="mailto:info@innovative.net.au">info@innovative.net.au</a> w <a href="http://www.innovative.net.au">www.innovative.net.au</a>			